

**ADDENDUM NO. 3****BID NO. 23-05  
SEWER REHABILITATION  
(GILES LANE & ROUTE 40 AREAS)**

To all holders of the specifications, the following corrections are hereby made. All other items shall remain unchanged. This addendum shall become part of the Contract Documents for the above referenced project.

**Acknowledgement of Addendum**

Name: \_\_\_\_\_

Company: \_\_\_\_\_

Date: \_\_\_\_\_

Signature: \_\_\_\_\_

**TOPICS FROM PRE-BID MEETING HELD FEBRUARY 2, 2023**

Q1: What are the pipe materials, clay or concrete?

**A1: The material for each pipe segment within the scope of the project has been corrected to Non-Reinforced Concrete. Bidders should also note that this type of Non-Reinforced Concrete pipe is a Heavy-Walled 10" pipe and it may have any inner diameter that differs from what is typically expected from 10" concrete pipe. The successful bidder will be required to verify inner diameters before ordering liner materials. (corrected documents are attached to this addendum)**

Q2: Are there any features on the project drawings that should not be included in the scope of work?

**A2: Pipe segment SP-0627 is PVC at approximately 85 linear feet and should not be included in the scope of work. Also, SMH-1090 has been verified to be on a separate gravity line not in the scope of this project. (corrected documents are attached to this addendum)**

Q3: Can bidders be supplied with a summary of defects or video inspection data?

**A3: The most recent POSM inspection data is available via the following shared drive link: [https://aberdeenmd-my.sharepoint.com/:f:/g/personal/cmaistros\\_aberdeenmd\\_gov/En2dKQbZqgIDiFf8t4xrO4sBlfyLIZvpA225oFGGczVw7A?e=VRYnFS](https://aberdeenmd-my.sharepoint.com/:f:/g/personal/cmaistros_aberdeenmd_gov/En2dKQbZqgIDiFf8t4xrO4sBlfyLIZvpA225oFGGczVw7A?e=VRYnFS) This file contains POSM video inspections and pipe plots with defect summaries. *The drive is password protected, qualified bidders should contact Shawn Brogan [sbrogan@aberdeenmd.gov](mailto:sbrogan@aberdeenmd.gov) or Costa Maistros [cmaistros@aberdeenmd.gov](mailto:cmaistros@aberdeenmd.gov) via email for access.***

Q4: Who will be responsible for bypassing operations and traffic control?

**A4: The City will arrange traffic control and road closures in coordination with the Contractor and prevailing SHA authorities as required by the scope of work. The City will also manage the flow control of area pump stations and necessary line stopping / bypass operations. Bidders shall take note that due to flow control requirements, pipe segments SP-0581, SP-0582 and SP-0583 must each be completed in one overnight working shift so flow can be restored. (SP-0581, SP-0582 and SP-0583 are downstream of a force main discharge and cannot be bypassed longer than one overnight shift.)**

Q5: Will hydrants be available in the area, or will the contractor need to bring in water?

**A5: The City will make hydrants in the area available for lining operations. Hydrant locations have been added to the project drawings. (corrected documents are attached to this addendum)**

Q6: Will a post rehabilitation cleaning and camera inspection be required?

**A6: The Contractor will be required to clean and camera each pipe segment after the completion of the rehabilitation project. PACP data shall be given to the City. In support of these cleaning and inspection operations, the Contractor may fill their trucks with City Hydrants and dump wastewater materials at the City WWTP in coordination with on-site City personnel.**

Q7: Who are the designated contacts with the City of Aberdeen?

**A7: The primary contact for the project and contract will be Costa Maistros [cmaistros@aberdeenmd.gov](mailto:cmaistros@aberdeenmd.gov). The on-site contact while the project is active will be Josh Quesenbery [jquesenbery@aberdeenmd.gov](mailto:jquesenbery@aberdeenmd.gov).**

***Please see the attached project drawings that have been corrected as detailed above.***

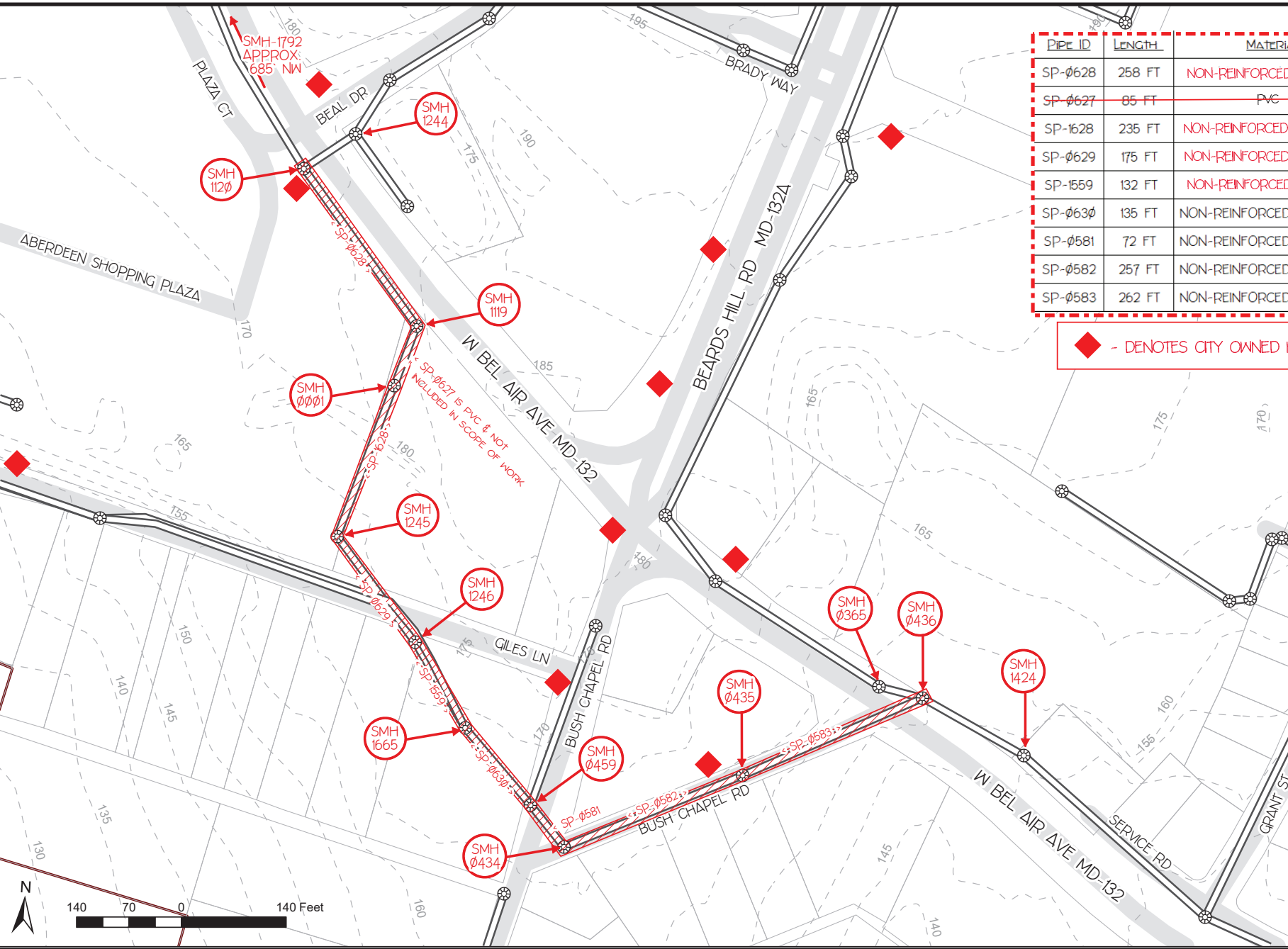

PIPE ID	LENGTH	MATERIAL	DIAMETER
SP-0628	258 FT	NON-REINFORCED CONCRETE	10 IN
SP-0627	85 FT	PVC	10 IN
SP-1628	235 FT	NON-REINFORCED CONCRETE	10 IN
SP-0629	175 FT	NON-REINFORCED CONCRETE	10 IN
SP-1559	132 FT	NON-REINFORCED CONCRETE	10 IN
SP-0630	135 FT	NON-REINFORCED CONCRETE	10 IN
SP-0581	72 FT	NON-REINFORCED CONCRETE	10 IN
SP-0582	257 FT	NON-REINFORCED CONCRETE	10 IN
SP-0583	262 FT	NON-REINFORCED CONCRETE	10 IN

◆ - DENOTES CITY OWNED HYDRANT

**23-05**  
**GILES LN AREA**  
**SEWER MAIN LINING**  
**AND MANHOLE REHAB**

**CAP#: UTL-22-15**

**DRAWINGS PREPARED BY:**  
**C. MAISTROS 10-17-2022**

**PAGE 01**